

5.

IN-LINE SWIVELS

Taimi's patented ball-less swivels bring unmatched reliability to hydraulic systems by eliminating internal wear points and preventing leaks. The result: longer service life, minimal downtime, and lower maintenance costs. Trusted by some of the world's largest machinery manufacturers, Taimi swivels are the toughest on the market.



90° SWIVELS STANDARD SERIES

Meet the wide range of 90° Swivel- standard series, designed with the highest standard of durability. Taimi's unique ball-less technology brings reliability to your hydraulic system increasing service life and cutting out leakages. This means higher productivity and lower operating costs.



WHY CHOOSE TAIMI IN-LINE SWIVELS ?

- **Pressure Spikes Protection™**
- **Easy and quick to repack**
- **Triple Seal Protection™**
- **Supports Higher pressure**
- **Fewer interruptions / Won't pull apart**
- **Durable**
- **Low maintenance**
- **Reduces leakage**
- **Custom solutions available**

HOW TO ORDER

SZ	J	12	M	J	12	M
SWIVEL DESIGNATOR	HOSE CONNECTION TYPE J = JIC (37°) F = NPT P = BSPP S = ORFS M = Metric	SHANK SIZE	SHANK CONFIGURATION M = MALE	HOUSING HOSE CONNECTION TYPE J = JIC (37°) FLARE JB = COMBO JIC 37° FLARE - SAE (O-RING BOSS) F = NPT P = BSPP S = ORFS (O-RING FACE SEAL) M = METRIC	HOUSING 1/16 of an inch M = MALE F = FEMALE	HOUSING CONFIGURATION M = MALE F = FEMALE

WHY CHOOSE TAIMI 90° SWIVELS-STANDARD SERIES ?

- **Patented ball-less design**
- **No snap ring, will not dismantle**
- **Triple Seal Protection™**
- **Pressure Spikes Protection™**
- **Easy and quick to repack**
- **Great side loads resistance**
- **A product that pays back: less leaking and better wear resistance**

HOW TO ORDER

SZ90	J	12	M	B	12	F
90° SWIVEL DESIGNATOR	HOSE CONNECTION TYPE J = JIC (37°) FLARE F = NPT P = BSPP S = ORFS (O-RING FACE SEAL) M = METRIC	HOSE SIZE	SHANK CONFIGURATION M = MALE	HOUSING HOSE CONNECTION TYPE J = JIC (37°) FLARE B = SAE (O-RING BOSS) F = NPT P = BSPP S = ORFS (O-RING FACE SEAL) M = METRIC	SHANK SIZE 1/16 of an inch	HOUSING CONFIGURATION M = MALE F = FEMALE

Part numbers in orange are usually in stock. Other products are manufactured to order

IN LINE SWIVELS

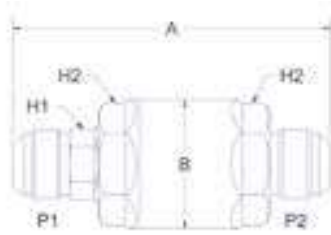

PART NU	IMPERIAL			METRIC			P1 - THREAD IN	P2 - THREAD OUT	H1 (INCH)	H2 (INCH)	SEAL KIT
	A (INCH)	B (INCH)	C (INCH)	A (MM)	B (MM)	C (MM)					
MALE JIC (37° FLARE) - MALE JIC (37° FLARE)											
SZ-J06M-J06M	2,98"	1,22"	-	76	31	-	9/16" - 18 UNF	9/16" - 18 UNF	1/2"	1"	SZ-06-001SK-A
SZ-J08M-J08M	3,84"	1,47"	-	98	37	-	3/4" - 16 UNF	3/4" - 16 UNF	11/16"	1 1/4"	SZ-08-001SK-A
SZ-J10M-J10M	4,05"	1,72"	-	103	44	-	7/8" - 14 UNF	7/8" - 14 UNF	13/16"	1 1/2"	SZ-10-001SK-A
SZ-J12M-J12M	4,89"	1,97"	-	124	50	-	1 1/16" - 12 UN	1 1/16" - 12 UN	15/16"	1 5/8"	SZ-12-001SK-A
SZ-J16M-J16M	5,57"	2,29"	-	141	58	-	1 5/16" - 12 UN	1 5/16" - 12 UN	1 3/16"	1 7/8"	SZ-16-001SK-A
SZ-J20M-J20M	6,05"	2,88"	-	154	73	-	1 5/8" - 12 UN	1 5/8" - 12 UN	1" 1/2	2" 3/8	SZ-20-001SK-A
SZ-J24M-J24M	6,43"	3,12"	-	163	79	-	1 7/8" - 12 UN	1 7/8" - 12 UN	1 3/4"	2 1/2"	SZ-24-001SK-A
SZ-J32M-J32M	7,71"	3,97"	-	196	101	-	2 1/2" - 12 UN	2 1/2" - 12 UN	2 5/16"	3 1/4"	SZ-32-001SK-A
MALE JIC (37° FLARE) - COMBO- FEMALE JIC (37° FLARE) / FEMALE O-RING BOSS (ORB) / SAE J1926-3											
SZ-J06M-JB06F	2,59"	1,22"	-	66	31	-	9/16" - 18 UNF	9/16" - 18 UNF	1/2"	1"	SZ-06-001SK-A
SZ-J08M-JB08F	3,28"	1,47"	-	83	37	-	3/4" - 16 UNF	3/4" - 16 UNF	11/16"	1 1/4"	SZ-08-001SK-A
SZ-J10M-JB10F	3,43"	1,72"	-	87	44	-	7/8" - 14 UNF	7/8" - 14 UNF	13/16"	1" 1/2	SZ-10-001SK-A
SZ-J12M-JB12F	4,14"	1,97"	-	105	50	-	1 1/16" - 12 UN	1 1/16" - 12 UN	15/16"	1 5/8"	SZ-12-001SK-A
SZ-J16M-JB16F	4,63"	2,29"	-	118	58	-	1 5/16" - 12 UN	1 5/16" - 12 UN	1 3/16"	1 7/8"	SZ-16-001SK-A
SZ-J20M-JB20F	5,05"	2,88"	-	128	73	-	1 5/8" - 12 UN	1 5/8" - 12 UN	1 1/2"	2 3/8"	SZ-20-001SK-A
SZ-J24M-JB24F	5,34"	3,12"	-	136	79	-	1 7/8" - 12 UN	1 7/8" - 12 UN	1" 3/4	2" 1/2	SZ-24-001SK-A
SZ-J32M-JB32F	6,46"	3,97"	-	164	101	-	2 1/2" - 12 UN	2 1/1" - 12 UN	2" 5/16	3" 1/4	SZ-32-001SK-A
MALE JIC (37° FLARE) - FEMALE PIPE (NPT)											
SZ-J08M-F08F	3,09"	1,47"	-	78	37	-	3/4" - 16 UNF	1/2" NPT	11/16"	1 1/4"	SZ-08-001SK-A
SZ-J12M-F12F	3,95"	1,97"	-	100	50	-	1 1/16" - 12 UN	3/4" NPT	15/16"	1" 5/8	SZ-12-001SK-A
SZ-J16M-F16F	4,44"	2,22"	-	113	56	-	1 5/16" - 12 UN	1" NPT	1" 3/16	1" 7/8	SZ-16-001SK-A
SZ-J20M-F20F	5,12"	2,88"	-	130	73	-	1 5/8" - 12 UN	1 1/4" NPT	1" 1/2	2" 3/8	SZ-20-001SK-A
MALE JIC (37° FLARE) - FEMALE BSPP											
SZ-J12M-P12F	3,89"	1,97"	-	99	50	-	1 1/16" - 12 UN	G 3/4"	15/16"	1" 5/8	SZ-12-001SK-A
SZ-J16M-P16F	4,44"	2,29"	-	113	58	-	1 5/16" - 12 UN	G 1"	1" 3/16	1" 7/8	SZ-16-001SK-A
MALE JIC (37° FLARE) - MALE BSPP											
SZ-J12M-P12M	4,45"	1,97"	-	113	50	-	1 1/16" - 12 UN	G 3/4"	15/16"	1" 5/8	SZ-12-001SK-A
SZ-J16M-P16M	5,19"	2,29"	-	132	58	-	1 5/16" - 12 UN	G 1"	1" 3/16	1" 7/8	SZ-16-001SK-A

PART NU	IMPERIAL			METRIC			P1 - THREAD IN	P2 - THREAD OUT	H1 (INCH)	H2 (INCH)	SEAL KIT
	A (INCH)	B (INCH)	C (INCH)	A (MM)	B (MM)	C (MM)					
MALE PIPE (NPT) - FEMALE PIPE (NPT)											
SZ-F06M-F06F	2,42"	1,35"	-	61	34	-	-	-	-	-	-
SZ-F08M-F08F	2,97"	1,53"	-	75	39	-	1/2" NPT	1/2" NPT	3/4"	1 5/16"	SZ-08-002SK-A
SZ-F12M-F12F	3,86"	1,97"	-	98	50	-	3/4" NPT	3/4" NPT	15/16"	1 5/8"	SZ-12-001SK-A
SZ-F16M-F16F	4,13"	2,22"	-	105	56	-	1" NPT	1" NPT	1 3/16"	1 7/8"	SZ-16-001SK-A
SZ-F20M-F20F	4,72"	2,88"	-	120	73	-	1 1/4" NPT	1 1/4" NPT	1 1/2"	2 3/8"	SZ-20-001SK-A
SZ-F24M-F24F	5,18"	3,12"	-	132	79	-	-	-	-	-	-
SZ-F32M-F32F	5,78"	3,97"	-	147	101	-	-	-	-	-	-
MALE PIPE (NPT) - COMBO FEMALE JIC (37° FLARE) / FEMALE O-RING BOSS (ORB) / SAE J1926-3											
SZ-F12M-JB12F	4,06"	1,97"	-	103	50	-	3/4" NPT	1 1/16" - 12 UN	15/16"	1 5/8"	SZ-12-001SK-A
SZ-F16M-JB16F	4,33"	2,28"	-	110	58	-	1" NPT	1 5/16" - 12 UN	1 3/16"	1 7/8"	SZ-16-001SK-A
SZ-F20M-JB20F	4,72"	2,88"	-	120	73	-	1 1/4" NPT	1 5/8" - 12 UN	1 1/2"	2 3/8"	SZ-20-001SK-A
MALE BSPP - MALE BSPP											
SZ-P06M-P06M	2,80"	1,34"	-	71	34	-	G 3/8"	G 3/8"	5/8"	1 5/16"	SZ-06-001SK-A
SZ-P08M-P08M	3,46"	1,54"	-	88	39	-	G 1/2"	G 1/2"	3/4"	1 5/16"	SZ-08-002SK-A
SZ-P10M-P10M	3,78"	1,85"	-	96	47	-	G 5/8"	G 5/8"	-	-	SZ-10-001SK-A
SZ-P12M-P12M	4,29"	1,97"	-	109	50	-	G 3/4"	G 3/4"	15/16"	1 5/8"	SZ-12-001SK-A
SZ-P16M-P16M	5,12"	2,28"	-	130	58	-	G 1"	G 1"	1 3/16"	1 7/8"	SZ-16-001SK-A
SZ-P20M-P20M	5,31"	2,87"	-	135	73	-	G 1 1/4"	G 1 1/4"	-	-	SZ-20-001SK-A
MALE BSPP - FEMALE BSPP											
SZ-P06M-P06F	2,32"	1,34"	-	59,00	34,00	-	G 3/8"	G 3/8"	5/8"	1 5/16"	SZ-06-001SK-A
SZ-P08M-P08F	2,95"	1,54"	-	75	39	-	G 1/2"	G 1/2"	3/4"	1 5/16"	SZ-08-002SK-A
SZ-P10M-P10F	3,19"	1,85"	-	81	47	-	G 5/8"	G 5/8"	15/16"	1" 5/8	SZ-10-001SK-A
SZ-P12M-P12F	3,74"	1,97"	-	95	50	-	G 3/4"	G 3/4"	15/16"	1 5/8"	SZ-12-001SK-A
SZ-P16M-P16F	4,33"	2,28"	-	110	58	-	G 1"	G 1"	1 3/16"	1 7/8"	SZ-16-001SK-A
SZ-P20M-P20F	4,53"	2,87"	-	115	73	-	G 1 1/4"	G 1 1/4"	1" 1/2	2" 3/8	SZ-20-001SK-A
SZ-J16M-P16M	5,19"	2,29"	-	132	58	-	1 5/16" - 12 UN	G 1"	1" 3/16	1" 7/8	SZ-16-001SK-A

PART NU	IMPERIAL			METRIC			P1 - THREAD IN	P2 - THREAD OUT	H1 (INCH)	H2 (INCH)	SEAL KIT
	A (INCH)	B (INCH)	C (INCH)	A (MM)	B (MM)	C (MM)					
MALE ORFS (O-RING FACE SEAL) - MALE ORFS (O-RING FACE SEAL)											
SZ-S06M-S06M	2,80"	1,34"	-	71	34	-	11/16" - 16 UNF	11/16" - 16 UNF	5/8"	1 1/8"	SZ-06-002SK-A
SZ-S08M-S08M	3,50"	1,58"	-	89	40	-	13/16" - 16 UNF	13/16" - 16 UNF	3/4"	1 5/16"	SZ-08-002SK-A
SZ-S10M-S10M	3,78"	1,85"	-	96	47	-	1" - 14 UNS	1" - 14 UNS	15/16"	1" 5/8	SZ-10-002SK-A
SZ-S12M-S12M	4,45"	2,17"	-	113	55	-	1 3/16" - 12 UN	1 3/16" - 12 UN	1 1/16"	1 3/4"	SZ-12-002SK-A
SZ-S16M-S16M	5,09"	2,41"	-	129	61	-	1 7/16" - 12 UN	1 7/16" - 12 UN	1 5/16"	2"	SZ-16-002SK-A
SZ-S20M-S20M	5,43"	2,87"	-	138	73	-	1 11/16" - 12 UN	1 11/16" - 12 UN	1 9/16"	2 3/8"	SZ-20-002SK-A
SZ-S24M-S24M	5,83"	3,23"	-	148	82	-	2" - 12 UN	2" - 12 UN	1 7/8"	2 3/4"	SZ-24-001SK-A
MALE ORFS (O-RING FACE SEAL) - COMBO FEMALE JIC (37° FLARE) / FEMALE O-RING BOSS (ORB) / SAE J1926-3											
SZ-S12M-JB12F	3,98"	2,17"	-	101	55	-	1 3/16" - 12 UN	1 1/16" - 12 UN	1" 1/16	1" 3/4	SZ-12-002SK-A
SZ-S16M-JB16F	4,53"	2,41"	-	115	61	-	1 7/16" - 12 UN	1 5/16" - 12 UN	1" 5/16	2"	SZ-16-002SK-A
SZ-S20M-JB20F	4,78"	2,88"	-	121	73	-	1 11/16" - 12 UN	1 5/8" - 12 UN	1" 9/16	2" 3/8	SZ-20-002SK-A
MALE ORFS (O-RING FACE SEAL) - FEMALE ORFS (O-RING FACE SEAL)											
SZ-S08M-S08F	2,99"	1,57"	-	76	40	-	13/16" - 16 UNF	13/16" - 16 UNF	3/4"	1" 5/16	SZ-08-002SK-A
SZ-S10M-S10F	3,15"	1,85"	-	80	47	-	1" - 14 UNF	1" - 14 UNF	15/16"	1" 5/8	SZ-10-002SK-A
SZ-S12M-S12F	3,78"	2,17"	-	96	55	-	1 3/16" - 12 UN	1 3/16" - 12 UN	1 1/16"	1 3/4"	SZ-12-002SK-A
SZ-S16M-S16F	4,33"	2,40"	-	110	61	-	1 7/16" - 12 UN	1 7/16" - 12 UN	1 5/16"	2"	SZ-16-002SK-A
SZ-S20M-S20F	4,69"	2,87"	-	119	73	-	1 11/16" - 12 UN	1 11/16" - 12 UN	1 9/16"	2 3/8"	SZ-20-002SK-A
SZ-S24M-S24F	5,00"	3,23"	-	127	82	-	2" - 12 UN	2" - 12 UN	1" 7/8	2" 3/4	SZ-24-002SK-A
MALE METRIC (DIN 3852) - FEMALE BSPP											
SZ-M20SM-P08F	2,95"	1,54"	-	75	39	-	M20 X 1.5	G 1/2"	3/4"	1" 5/16	SZ-08-002SK-A
SZ-M24SM-P10F	3,23"	1,85"	-	82	47	-	M24 X 1.5	G 5/8"	15/16"	1" 5/8	SZ-10-002SK-A
SZ-M30SM-P12F	3,78"	2,17"	-	96	55	-	M30 X 2.0	G 3/4"	1 1/16"	1 3/4"	SZ-12-002SK-A
SZ-M36SM-P16F	4,25"	2,40"	-	108	61	-	M36 X 2.0	G 1"	1" 5/16	2"	SZ-16-002SK-A
SZ-M42SM-P20F	4,57"	2,87"	-	116	73	-	M42 X 2.0	G 1 1/4"	1" 9/16	2" 3/8	SZ-20-002SK-A
MALE METRIC (DIN 3852) - FEMALE ORFS (O-RING FACE SEAL)											
SZ-M30SM-S12F	3,82"	2,17"	-	97	55	-	M30 X 2.0	1 3/16" - 12 UN	1 1/16"	1 3/4"	SZ-12-002SK-A
SZ-M36SM-S16F	4,33"	2,40"	-	110	61	-	M36 X 2.0	1 7/16" - 12 UN	1 5/16"	2"	SZ-16-002SK-A
SZ-M42SM-S20F	4,69"	1,44"	-	119	37	-	M42 X 2.0	1 11/16" - 12 UN	1 9/16"	2 3/8"	SZ-20-002SK-A
MALE METRIC - MALE METRIC (DIN 3852)											
SZ-M20SM-M20SM	3,50"	1,54"	-	89	39	-	M20 X 1.5	M20 X 1.5	3/4"	1" 5/16	
SZ-M24SM-M24SM	3,78"	1,85"	-	96	47	-	M24 X 1.5	M24 X 1.5	15/16"	1 5/8"	SZ-10-002SK-A
SZ-M30SM-M30SM	4,45"	2,17"	-	113	55	-	M30 X 2.0	M30 X 2.0	1 1/16"	1 3/4"	SZ-12-002SK-A
SZ-M30SM-M36SM	4,57"	2,09"	-	116	53	-	M30 X 2.0	M30 X 2.0	1 1/16"	1 3/4"	SZ-12-002SK-A
SZ-M30SM-M42SM	4,65"	2,09"	-	118	53	-	M30 X 2.0	M30 X 2.0	1 1/16"	1 3/4"	SZ-12-002SK-A
SZ-M36SM-M36SM	5,04"	2,40"	-	128	61	-	M36 X 2.0	M36 X 2.0	1 5/16"	2"	SZ-16-002SK-A
SZ-M42SM-M42SM	5,39"	2,87"	-	137	73	-	M42 X 2.0	M42 X 2.0	1 9/16"	2 3/8"	SZ-20-001SK-A

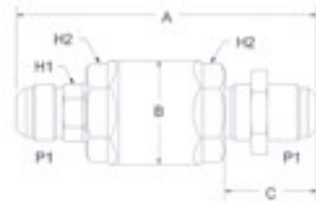

PART NU	IMPERIAL			METRIC			P1 - THREAD IN	P2 - THREAD OUT	H1 (INCH)	H2 (INCH)	SEAL KIT
	A (INCH)	B (INCH)	C (INCH)	A (MM)	B (MM)	C (MM)					
MALE JIC (37° FLARE) - MALE JIC (37° FLARE) BULKHEAD											
SZ-J06M-J06MB	3,71"	1,22"	1,25"	94	31	32	9/16" - 18 UNF	9/16" - 18 UNF	1/2"	1"	SZ-06-001SK-A
SZ-J08M-J08MB	4,59"	1,47"	1,50"	117	37	38	3/4" - 16 UNF	3/4" - 16 UNF	11/16"	1 1/4"	SZ-08-001SK-A
SZ-J10M-J10MB	4,90"	1,72"	-	124	44	-	7/8" - 14 UNF	7/8" - 14 UNF	13/16"	1 1/2"	SZ-10-001SK-A
SZ-J12M-J12MB	5,69"	1,97"	1,75"	145	50	44	1 1/16" - 12 UN	1 1/16" - 12 UN	15/16"	1 5/8"	SZ-12-001SK-A
SZ-J16M-J16MB	6,32"	2,29"	1,88"	161	58	48	1 5/16" - 12 UN	1 5/16" - 12 UN	1 3/16"	1 7/8"	SZ-16-001SK-A
SZ-J20M-J20MB	6,92"	2,88"	2,00"	176	73	51	1 5/8" - 12 UN	1 5/8" - 12 UN	1 1/2"	2 3/8"	SZ-20-001SK-A
MALE ORFS (O-RING FACE SEAL) - MALE ORFS BULKHEAD											
SZ-S06M-S06MB	3,62"	1,34"	1,26"	92	34	32	11/16" - 16 UNF	11/16" - 16 UNF	5/8"	1 1/8"	SZ-06-002SK-A
SZ-S08M-S08MB	4,25"	1,57"	1,30"	108	40	33	13/16" - 12 UNF	13/16" - 12 UNF	3/4"	1 5/16"	SZ-08-002SK-A
SZ-S10M-S10MB	4,53"	1,57"	-	110	40	-	1" - 14 UNF	1" - 14 UNF	1 1/16"	1 3/4"	SZ-10-002SK-A
SZ-S12M-S12MB	5,20"	2,17"	1,42"	132	55	36	1 3/16" - 12 UN	1 3/16" - 12 UN	1 1/16"	1 3/4"	SZ-12-002SK-A
SZ-S16M-S16MB	5,83"	2,40"	1,50"	148	61	38	1 5/16" - 12 UN	1 5/16" - 12 UN	1 5/16"	2"	SZ-16-002SK-A
SZ-S20M-S20MB	6,30"	2,87"	1,61"	160	73	41	1 11/16" - 12 UN	2 11/16" - 12 UN	1 9/16"	2 3/8"	SZ-20-002SK-A
MALE BSPP - MALE BSPP BULKHEAD											
SZ-P06M-P06MB	3,58"	1,34"	1,26"	91	34	32	G 3/8"	G 3/8"	5/8"	1"	SZ-06-002SK-A
SZ-P08M-P08MB	4,21"	1,54"	1,30"	107	39	33	G 1/2"	G 1/2"	3/4"	1 5/16"	SZ-08-002SK-A
SZ-P12M-P12MB	5,20"	1,97"	1,42"	132	50	36	G 3/4"	G 3/4"	15/16"	1 5/8"	SZ-12-001SK-A
SZ-P16M-P16MB	5,91"	2,28"	1,57"	150	58	40	G 1"	G 1"	1 3/16"	1 7/8"	SZ-16-001SK-A
MALE METRIC - MALE METRIC BULKHEAD (DIN 3852)											
SZ-M24SM-M24SMB	4,72"	1,85"	-	120	47	-	M24 X 1.5	M24 X 1.5	15/16"	1" 5/8	SZ-10-002SK-A
SZ-M30SM-M30SMB	5,59"	2,17"	-	142	55	-	M30 X 2.0	M30 X 2.0	1 1/16"	1 3/4"	SZ-12-002SK-A
SZ-M36SM-M36SMB	5,94"	2,40"	-	151	61	-	M36 X 2.0	M36 X 2.0	1 5/16"	2"	SZ-16-002SK-A
SZ-M42SM-M42SMB	7,09"	2,87"	2,52"	180	73	64	M42 X 2.0	M42 X 2.0	1 9/16"	2" 3/8	SZ-20-001SK-A