

# EINSTELLBARE T-VERSCHRAUBUNG MIT KONTERMUTTER UND O-RING

UNF/UN-2A Einschraubzapfen

Typ: 2055...3

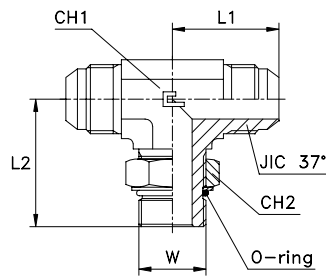

| Serie JIC | 20.... [bar] | 21.... [bar] | Artikelnr. | Ø Rohr M | Ø Rohr W | W         | L1   | L2   | CH1 | CH2       | JIC 37°   |
|-----------|--------------|--------------|------------|----------|----------|-----------|------|------|-----|-----------|-----------|
| UNIVERSAL | 400          | 400          | 205501.3   | 6        | 1/4      | 7/16-20   | 23   | 27   | 11  | 14        | 7/16-20   |
|           |              |              | 205502.3   | 8        | 5/16     | 1/2-20    | 24   | 29   | 14  | 17        | 1/2-20    |
|           | 350          | 350          | 205503.3   | 10       | 3/8      | 9/16-18   | 27,5 | 32   | 14  | 17        | 9/16-18   |
|           |              |              | 205504.3   | 12       | 1/2      | 3/4-16    | 32   | 37   | 19  | 22        | 3/4-16    |
|           |              |              | 205505.3   | 14-15-16 | 5/8      | 7/8-14    | 37   | 43   | 22  | 27        | 7/8-14    |
|           |              |              | 205506.3   | 18-20    | 3/4      | 1 1/16-12 | 42   | 49,5 | 27  | 32        | 1 1/16-12 |
|           | 290          | 290          | 205507.3   | 25       | 1        | 1 5/16-12 | 46   | 52   | 33  | 41        | 1 5/16-12 |
|           | 240          | 240          | 205508.3   | 30-32    | 1 1/4    | 1 5/8-12  | 53   | 58   | 41  | 50        | 1 5/8-12  |
|           |              |              | 205509.3   | 38       | 1 1/2    | 1 7/8-12  | 59   | 60   | 48  | 55        | 1 7/8-12  |
|           | 400          | 400          | 205510.3   | 6        | 1/4      | 1/2-20    | 24   | 29   | 14  | 17        | 7/16-20   |
|           | 350          | 350          | 205511.3   | 6        | 1/4      | 9/16-18   | 24   | 32   | 14  | 17        | 7/16-20   |
|           |              |              | 205512.3   | 10       | 3/8      | 3/4-16    | 29,5 | 37   | 19  | 22        | 9/16-18   |
|           |              |              | 205513.3   | 12       | 1/2      | 7/8-14    | 34   | 43   | 22  | 27        | 3/4-16    |
|           |              |              | 205514.3   | 12       | 1/2      | 1 1/16-12 | 36   | 49,5 | 27  | 32        | 3/4-16    |
|           |              |              | 205515.3   | 14-15-16 | 5/8      | 3/4-16    | 37   | 39,5 | 22  | 22        | 7/8-14    |
|           |              |              | 205516.3   | 14-15-16 | 5/8      | 1 1/16-12 | 39   | 49,5 | 27  | 32        | 7/8-14    |
|           |              |              | 205517.3   | 18-20    | 3/4      | 3/4-16    | 42   | 41,5 | 27  | 22        | 1 1/16-12 |
|           |              |              | 205518.3   | 18-20    | 3/4      | 7/8-14    | 42   | 47   | 27  | 27        | 1 1/16-12 |
|           | 290          | 290          | 205519.3   | 18-20    | 3/4      | 1 5/16-12 | 45   | 52   | 33  | 41        | 1 1/16-12 |
|           |              |              | 205520.3   | 25       | 1        | 1 1/16-12 | 46   | 49,5 | 33  | 32        | 1 5/16-12 |
| 240       | 240          | 205521.3     | 25         | 1        | 1 5/8-12 | 52        | 58   | 41   | 50  | 1 5/16-12 |           |

**Hinweis:** Wenn Sie eine Verschraubung in Edelstahl bestellen wollen, den Code 20.. am Anfang durch 21.. ersetzen.  
Lieferzeit auf Anfrage.