

EINSTELLBARE T-VERSCHRAUBUNG MIT KONTERMUTTER UND O-RING

Zöll. Einschraubzapfen - Metr.Einschraubzapfen - zylindrisch

Typ: 2053...3

Typ: 2054...3

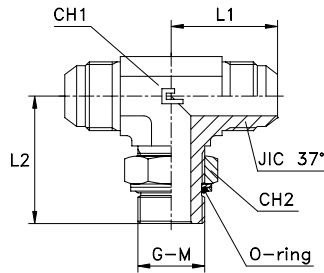

| Serie JIC | 20.... [bar] | 21.... [bar] | Artikelnr. | Ø Rohr M | Ø Rohr W | G | L1 | L2 | CH1 | CH2 | JIC 37° |
|-----------|--------------|--------------|------------|----------|----------|-------|------|------|-----|-----|-----------|
| UNIVERSAL | 350 | 350 | 205301.3 | 6 | 1/4 | 1/8 | 23 | 26 | 11 | 14 | 7/16-20 |
| | 315 | 315 | 205302.3 | 8 | 5/16 | 1/4 | 24 | 32 | 14 | 19 | 1/2-20 |
| | | | 205303.3 | 10 | 3/8 | 1/4 | 27,5 | 32 | 14 | 19 | 9/16-18 |
| | 250 | 250 | 205304.3 | 12 | 1/2 | 3/8 | 32 | 37 | 19 | 22 | 3/4-16 |
| | | | 205305.3 | 14-15-16 | 5/8 | 1/2 | 37 | 43 | 22 | 27 | 7/8-14 |
| | | | 205306.3 | 18-20 | 3/4 | 3/4 | 42 | 49 | 27 | 36 | 1 1/16-12 |
| | 200 | 200 | 205307.3 | 25 | 1 | 1 | 46 | 52 | 33 | 41 | 1 5/16-12 |
| | | | 205308.3 | 30-32 | 1 1/4 | 1 1/4 | 53 | 58 | 41 | 50 | 1 5/8-12 |
| | 160 | 160 | 205309.3 | 38 | 1 1/2 | 1 1/2 | 59 | 60 | 48 | 55 | 1 7/8-12 |
| | 315 | 315 | 205310.3 | 6 | 1/4 | 1/4 | 24 | 32 | 14 | 19 | 7/16-20 |
| | 250 | 250 | 205311.3 | 6 | 1/4 | 3/8 | 29 | 37 | 19 | 22 | 7/16-20 |
| | | | 205312.3 | 6 | 1/4 | 1/2 | 31 | 43 | 22 | 27 | 7/16-20 |
| | 350 | 350 | 205313.3 | 8 | 5/16 | 1/8 | 24 | 30 | 14 | 14 | 1/2-20 |
| | 250 | 250 | 205314.3 | 8 | 5/16 | 3/8 | 29 | 37 | 19 | 22 | 1/2-20 |
| | | | 205315.3 | 10 | 3/8 | 3/8 | 29,5 | 37 | 19 | 22 | 9/16-18 |
| | | | 205316.3 | 10 | 3/8 | 1/2 | 31,5 | 43 | 22 | 27 | 9/16-18 |
| | 315 | 315 | 205317.3 | 12 | 1/2 | 1/4 | 32 | 37 | 19 | 19 | 3/4-16 |
| | 250 | 250 | 205318.3 | 12 | 1/2 | 1/2 | 34 | 43 | 22 | 27 | 3/4-16 |
| | | | 205319.3 | 12 | 1/2 | 3/4 | 36 | 49 | 27 | 36 | 3/4-16 |
| | | | 205320.3 | 14-15-16 | 5/8 | 3/8 | 37 | 37,5 | 22 | 22 | 7/8-14 |
| | | | 205321.3 | 14-15-16 | 5/8 | 3/4 | 39 | 49 | 27 | 36 | 7/8-14 |
| | | | 205322.3 | 18-20 | 3/4 | 1/2 | 42 | 47 | 27 | 27 | 1 1/16-12 |
| | 200 | 200 | 205323.3 | 18-20 | 3/4 | 1 | 45 | 52 | 33 | 41 | 1 1/16-12 |
| | 250 | 250 | 205324.3 | 25 | 1 | 3/4 | 46 | 50 | 33 | 36 | 1 5/16-12 |
| | 200 | 200 | 205325.3 | 25 | 1 | 1 1/4 | 52 | 58 | 41 | 50 | 1 5/16-12 |
| | | | 205326.3 | 30-32 | 1 1/4 | 1 | 53 | 58 | 41 | 41 | 1 5/8-12 |
| | | | 205327.3 | 38 | 1 1/2 | 1 1/4 | 59 | 60 | 48 | 50 | 1 7/8-12 |

Hinweis: Wenn Sie eine Verschraubung in Edelstahl bestellen wollen, den Code 20.. am Anfang durch 21.. ersetzen.

| Serie JIC | 20.... [bar] | 21.... [bar] | Artikelnr. | Ø Rohr M | Ø Rohr W | M | L1 | L2 | CH1 | CH2 | JIC 37° |
|-----------|--------------|--------------|------------|----------|----------|--------|------|------|-----|-----|-----------|
| UNIVERSAL | 350 | 350 | 205401.3 | 6 | 1/4 | 10x1 | 23 | 27 | 11 | 14 | 7/16-20 |
| | 315 | 315 | 205402.3 | 8 | 5/16 | 12x1,5 | 24 | 31 | 14 | 17 | 1/2-20 |
| | | | 205403.3 | 10 | 3/8 | 14x1,5 | 27,5 | 33 | 14 | 19 | 9/16-18 |
| | | | 205404.3 | 12 | 1/2 | 16x1,5 | 32 | 38 | 19 | 22 | 3/4-16 |
| | 250 | 250 | 205405.3 | 14-15-16 | 5/8 | 22x1,5 | 37 | 42 | 22 | 27 | 7/8-14 |
| | | | 205406.3 | 18-20 | 3/4 | 27x2 | 42 | 50,5 | 27 | 32 | 1 1/16-12 |
| | 200 | 200 | 205407.3 | 25 | 1 | 33x2 | 46 | 52,5 | 33 | 41 | 1 5/16-12 |
| | | | 205408.3 | 30-32 | 1 1/4 | 42x2 | 53 | 58 | 41 | 50 | 1 5/8-12 |
| | 160 | 160 | 205409.3 | 38 | 1 1/2 | 48x2 | 59 | 63 | 48 | 55 | 1 7/8-12 |
| | 315 | 315 | 205410.3 | 6 | 1/4 | 12x1,5 | 24 | 31 | 14 | 17 | 7/16-20 |
| | 350 | 350 | 205411.3 | 8 | 5/16 | 10x1 | 24 | 28 | 14 | 14 | 1/2-20 |
| | 315 | 315 | 205412.3 | 8 | 5/16 | 14x1,5 | 24 | 33 | 14 | 19 | 1/2-20 |
| | | | 205413.3 | 10 | 3/8 | 16x1,5 | 29,5 | 38 | 19 | 22 | 9/16-18 |
| | | | 205414.3 | 12 | 1/2 | 18x1,5 | 32 | 38 | 19 | 24 | 3/4-16 |
| | | | 205415.3 | 14-15-16 | 5/8 | 18x1,5 | 37 | 40 | 22 | 24 | 7/8-14 |
| | 250 | 250 | 205416.3 | 14-15-16 | 5/8 | 20x1,5 | 37 | 42 | 22 | 27 | 7/8-14 |
| | | | 205417.3 | 18-20 | 3/4 | 22x1,5 | 42 | 46 | 27 | 27 | 1 1/16-12 |
| | | | 205418.3 | 25 | 1 | 27x2 | 46 | 52,5 | 33 | 32 | 1 5/16-12 |

Hinweis: Wenn Sie eine Verschraubung in Edelstahl bestellen wollen, den Code 20.. am Anfang durch 21.. ersetzen. Lieferzeit auf Anfrage.