

# EASY FIT

## ADAPTORS

### O82H10

CARTRIDGE EF  
 CARTUCHO EF  
 STECKMODUL EF  
 CARTUCCIA EF

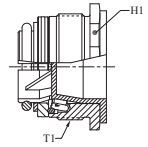

PART. REF.	HOSE BORE		CARTRIDGE SIZE	DIMENSIONS mm		W.P. bar	TORQUE Nm
	DN	Size		T <sub>1</sub>	H <sub>1</sub>		
O82H10-04	10	- 04	1/4"	M18x1	19	350	25-35
O82H10-06	13	- 06	3/8"	M22x1	23	350	30-40
O82H10-08	16	- 08	1/2"	M25x1	26	350	40-50
O82H10-12	23	- 12	3/4"	M33x1,5	34	280	70-80

### A52032H

STRAIGHT ADAPTOR BSP MALE O-RING BOSS TYPE ISO 1179 EF FEMALE  
 ADAPTADOR RECTO MACHO BSP O-RING TIPO BOSS ISO 1179 EF HEMBRA  
 GERADER ADAPTER BSP AG O-RINGNUT ISO 1179 EF IG  
 ADATTATORE DRITTO BSP MASCHIO CON O-RING TIPO BOSS ISO 1179 EF FEMMINA

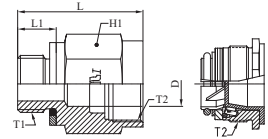

PART. REF.	THREAD	PIPE	DIMENSIONS mm					W.P. bar
	T <sub>1</sub> (BSP)	D	Size	L	L <sub>1</sub>	H <sub>1</sub>	T <sub>2</sub>	
A52032H-04-04	1/4"-19	10	- 04	34,0	11,2	22	M18x1	350
A52032H-06-04	3/8"-19	10	- 04	34,0	11,2	22	M18x1	350
A52032H-06-06	3/8"-19	13	- 06	37,0	11,2	25	M22x1	350
A52032H-08-06	1/2"-14	13	- 06	40,0	14,5	27	M22x1	350
A52032H-08-08	1/2"-14	16	- 08	40,0	14,5	28	M25x1	350
A52032H-12-12	3/4"-14	23	- 12	50,5	14,5	38	M33x1,5	280
A52032H-16-12	1"-11	23	- 12	53,5	18,6	46	M33x1,5	280